



## Q5er – The Official Newsletter of the Skyview Radio Society

August 1, 2022

# Don't Miss It !!



## 2022 SKYVIEW RADIO SOCIETY SWAP N SHOP!

SUNDAY AUGUST 28, 2022 8:00am until 1:00pm

LOCATED AT OUR CLUB GROUNDS NEAR NEW KENSINGTON PA

Aprox 13 miles northeast of Pittsburgh

2335 Turkey Ridge Road

New Kensington, PA 15068

Talk-in 146.640- 131.8pl

Admission \$5.00 – Table space is \$5.00 (Bring your own table)

Great prizes

Door prizes

Begali CW key raffle

Breakfast and lunch served

Get your Skyview Burger and your Skyview Dipole Hotdog!

Contact: John Italiano WA3KFS - 724-339-3821

[K3mjw@arrl.net](mailto:K3mjw@arrl.net)

<https://www.facebook.com/SkyviewRadioSociety>

Location is near the intersection of Rt. 366 and Rt. 380

THERE ARE PEOPLE  
OUT THERE TRAINING  
FOR MARATHONS...  
AND HERE I AM,  
ON THE COUCH,  
TRYING TO LASSO  
THE REMOTE WITH  
MY PHONE CHARGER.

The Sunspots Are  
Here !!!

Time to exercise  
the 10-12-15-17-20  
meter bands

### Inside this issue:

FROM THE EDITOR	3
BUSINESS MEETING MINUTES	4
QRP AND QRPP POWER	7
USED HF TRANSCEIVERS	9
LESSON LEARNED	12
SKYVIEW TABLE	12
UNIONTOWN GABFEST	13
NEW MEMBERS	14
KUL-LINKS	15

## 2022 is Skyview's 62nd Anniversary !!



**The Skyview Radio Society Clubhouse is the “Every Tuesday Place” . . .**

Something is going on at ‘the joint’ each and every Tuesday evening, from about 1900 hours to whenever.

See the general schedule of Tuesday events on the Skyview Web Page: <http://www.skyviewradio.net>

For the latest up-to-date plan, check the Groups.io Reflector at : <https://groups.io/g/K3MJW>

Directions are on: <http://www.skyviewradio.net>

Guests are always welcome !!

### From the Editor

At the last Skyview Business Meeting, Bob - WC3O asked us if we were getting anything out of the N1MMM+ articles that he has been writing. He said there is so much in the N1MM+ software that is a big task to try to distill it into simpler terms.

On the slim chance that there are more newsletter readers than there are people who attend the General Business Meetings, I thought that I would ask you readers that question.

Please send me an email ( k3jzd@arrl.net ) if you are getting anything out of Bob's N1MM+ articles and would like to see him continue to try to cover another N1MM+ feature or two in each future newsletter issue.

Jody - K3JZD

### From the Treasurer

As you saw on the first page, our Swap & Shop will be held in August. All Skyview members are invited to assist during this fund raising event.

Setup will occur on Saturday August 27th. All who are available can come to the clubhouse some time between 0900 and 1000 to assist with the setup.

The event will be held on Sunday, August 28th. You have to contact John - WA3KFS to get signed up for a time slot for some event work assignment. Slots are available from 0600 until 1300. No experience required. John pairs new volunteers with experienced volunteers. John is available at the joint on Tuesday evenings and on the Thursday evening net

Tear down and cleanup begins at 1300 on Sunday . More hands are always needed

Jody - K3JZD

**Ham Radio is a Contact Sport**

**Use the Skyview Facilities At Your Own Risk.**

Follow <https://groups.io/g/K3MJW> for updates.

**Skyview Radio Society is recognized by the Internal Revenue Service as a charitable non-profit organization under Section 501(c)(3) of the IRS Code. Donations to Skyview are tax deductible to the extent permitted by law.**

Here is another issue. . . . .

Not saying it is the last one that I will publish. But it could be . . . . Jody - K3JZD

( This is a THIN ISSUE—It could have been a VERY THIN ISSUE )

*Get your facts first, then you can distort them as you please. - Mark Twain*



## July Business Meeting Minutes

de Don - WA3HGW

### Skyview Radio Society Monthly Business Meeting – July 5, 2022

**Call to Order:** 7:30 PM by President Scott Gliebe, AC3GB.

**Attending** – 23 members: WA3HGW, N3WMC, K3FAZ, KC3LHW, W3BUW, K3STL, AC3GB, N3TIN, NK3P, WA3LCY, KC3UIJ, AC3IE, KC3PXQ, N2MA, WC3O, AB3GY, KQ3S, K3JZD, AJ3O, AG3I, KB3EYY, WA3KFS AND WQ3Q.

**Prior Meeting Minutes:** The minutes of the June 7, 2022 meeting were distributed for member review. A motion to accept the minutes as presented was made by W3BUW and seconded by NK3P. The motion passed without objection.

**Treasurer's Report:** Treasurer Jody, K3JZD, reviewed the latest financial report. The financial report as of 30 June 2022 is attached. The treasury is in good shape and revenue is running a bit ahead of projections. The largest expense this month was propane refill, which was less than the previous fill up. A motion to accept the Treasurer's Report as presented was made by KC3PXQ and seconded by WA3LCY. The motion passed without objection.

**Membership Report:** Tom, AB3GY, advised there is one new member applications this month. AB3GY made a motion to open the membership rolls. WA3KFS seconded the motion. The application is from Chris Vanek, KC3UIJ from Pittsburgh. He is a Technician class ham. Sponsors are K3STL, KC3PXQ and KC3LHW. Chris' application was approved with no exception. AB3GY made a motion to accept the application which was seconded by AJ3O. AB3GY made a motion to close the membership rolls which was seconded by W3BUW. The motion passed without exception. Membership now stands at 148.

**Radio Officer Report:** All the radios are working well. There was a problem reported with the 40 meter beam. This was traced to a bad PL259 which was replaced, resolving the problem. The new 10 meter vertical antenna is assembled and ready to install. We need a time with favorable weather to climb the tower and complete the installation.

**Kitchen Report:** The kitchen fund balance is \$87 plus some income yet to be counted. Kitchen supplies are good and replenished today.

**VE Report:** At the June VE session we had 3 new Technicians and 3 upgrades to General class. The next VE session is

July 16. We presently have no candidates signed up for the July session, but last month had 7 sign up in the week prior to the session. Because of the Parks On The Air event going on this weekend, we need to have at least 6 VEs for this session. Some of our regular VE examiners will be doing the POTA event.

**Newsletter:** The June issue of the *Q5er* is out. Jody is looking for newsletter submissions by July 15 for the August issue.

**Facilities:** Nothing to report this month. All is well.

**Building Committee:** Marty, AG3I, reviewed the results of the June 13 Board of Directors meeting. The BOD voted to proceed with the building expansion as originally voted by the membership over two years ago. Phase 1 is to modify the existing building to be ADA compliant by adding an addition on the north side of the building to contain two ADA compliant restrooms, widen the existing door opening and replace the exterior sidewalk leading to the new addition with one being ADA compliant. Phase 2 will be the expansion South to double the size of the meeting room. Funds for the Phase 1 expansion will use existing Unallocated funds from the treasury. Phase 2 meeting room expansion will use the funds previously allocated for the building expansion.

#### Calendar of Events:

July 9 & 10 – IARU Contest from Skyview

July 10 – Somerset, PA hamfest.

July 12 – Ice cream social at the clubhouse.

July 16 & 17 – Support Parks On The Air weekend club competition.

August 6 – Rescheduled DX Engineering & K3LR trip.

August 13 – Uniontown Gab Fest.

August 23 – Corn roast at the clubhouse.

August 29 – Skyview Swap-n-Shop.

**Old Business:** No action on the purchase of a tower climbing safety harness and votes on last meeting.

**New Business:** The August Swap-n-Shop was discussed:

John, WA3KFS, distributed the tickets to be sold by members to those in attendance. The remaining will be mailed.

John is looking for prize donations. We had fewer offered last year, and would like to increase for this year.

WA3BKD has donated one of his J pole 2meter/440 antennas.

The handicap porta-potty has been ordered.

**Elmer Night:** “Tall Guy” K3STL will do a presentation on QSL management.

**Net Report:** June net check-ins are 39, 39, 38, 35 and 37 for an average of 37.

**50/50 Drawing:** The total collected was \$31. The winner of \$15.50 was John, WA3KFS. John donated the proceeds to the club treasury.

**Meeting Adjourned:** A motion to adjourn was made by W3BUW and seconded by AJ3O. The motion passed without objection. The meeting was adjourned at 8:20 PM.

Respectfully Submitted,

Don Stewart – WA3HGW  
Secretary; Skyview Radio Society, Inc.



W3GH takes 1st place Multi/Multi High Power (Again) in the 2022 RTTY Round-up!

1.W3GH	223,608
2.NF3R	208,376
3.W8BAP	31,330
4.K5LRW	14,045

Congratulations all participating ops



A QRP Dummy Load

---

## QRP and QRPp Power

de Jody – K3JZD

---

One thing that is great about this hobby of ours is the diversity of the things that it offers.

We have ham bands in all portions of the RF spectrum to support both local and long distance communications. There is something going on in one or more of those ham bands 7x24.

We can choose from many different modes of communication: voice, Morse code, or one of the many digital modes now out there. And we do it over the air, wirelessly. (About the only communication mode we don't do is flag waving ! )

We can use all different levels of transmit power. Our maximum power limit is very generous.

We can choose to rag chew, operate contests, join nets, or participate in public service events.

We can connect computers to our radios to provide operating support or add features to our stations.

When properly trained, we can volunteer to be participants in the government's auxiliary emergency communications service.

We are not limited to just using store bought plug and play equipment. We can experiment with and use equipment and/or antennas that we have built ourselves.

We can operate from home or we can operate from any remote location that we can get to. Vacation homes, beaches, public parks and mountain tops are all popular remote operating locations. (And yes, there is a "Walmart Parking Lots On the Air" activity.)

We can do any, or all of these things. It is really a "to each his own" kind of a hobby.

I have checked off most of those boxes at one time or another. The only one I have not really had any interest in is operating at the maximum power limit. I have spent many of my licensed years operating SSB, using 100-400 watt transmitters.

Being computer oriented, I became interested in the small software defined radios (SDRs) whenever they showed up. I liked an affordable SDR transceiver kit called a SoftRock RXTX. While it would do any mode, that RXTX transmitter only produced one watt.

While one can use SSB when operating at lower power levels, it is more difficult to be heard whenever you are using SSB. One can be a whole lot more successful when using low power CW. But, after years and years of operating only SSB, my CW proficiency had faded badly.

Long story short, I committed to buying and building a SoftRock RXTX and using it on CW. I saw it as a way to experiment with low power and give me a reason to get my CW skills back. That RXTX build and setup involved my doing some modifications to the RXTX circuit and interfacing it to a custom Arduino based K3NG keyer that I built to obtain a real-time side tone and allow me to operate in a Semi-Break In Mode. But that is another story.

During my new pursuit of operating CW at a QRPp level (less than one watt output), I found that calling CQ did not get me very many responses. And answering other's CQs was not real productive either. I added a small amplifier to my RXTX to take me up to a CW QRP level (5 watts maximum). That helped a little. But I could often still spend a lot of time, without making a single contact. Even when using the so called QRP frequencies.

During this time period, I had also been working the monthly Straight Key Century Club (SKCC) Weekend Sprintathon (WES) events to improve my CW. I had typically been using 100 watts during these WES events. Noting that they also had a QRP class and a QRPp class, I tried doing QRP or QRPp for several months. While I did OK in the scoring for those low power classes, there were too many higher powered stations that were much more successful in answering CQs than I was. And quite often whenever I was calling CQ someone would not hear me, assume that it was an open frequency, and then begin to call CQ there. (It is easy to get an inferiority complex whenever you are using low power.)



I discovered the North American QRP CW Club (NAQCC) monthly Sprint events. During these monthly NAQCC QRP Sprint events, and the periodic NAQCC QRPP Sprint events, everyone was listening closely for weaker signals. This was a more of an ideal situation for me.

By this time, while I was still typically using my RXTX during the QRPP events, I was also using some of my other radios which allowed turning my power down to QRP levels.

For the regular June NAQCC QRP Sprint, I had used my K4 turned down to 4.9 watts. For the June NAQCC mW (QRPP) Sprint, I started out with my RXTX as usual. But a recent Windows 10 update had totally screwed up my SDR software configuration. So I turned my K4 down to just 0.9 watt and used it instead. (Yes, that was a lot of radio to use for working QRPP.)

I ended up being very successful in both of those June NAQCC Sprint events. I ended up in first place in the W3 call area in both of them. I was the overall high scorer in the mW Sprint, and I was the second highest overall scorer in the regular QRP Sprint. Best month that I have ever had for these events.

My antennas are not spectacular, so these results really surprised me.

6/24/22, 8:48 PM

NAQCC Jun 2022 Sprint

## NORTH AMERICAN QRP CW CLUB

June 2022 QRP/CW Sprint (#212)

SITE CONTENT

- [Home](#)
- [Awards](#)
- [Become A Member](#)
- [Challenges](#)
- [Contests/Sprints](#)
- [Autoblog](#)
- [Results](#)
- [General Rules](#)
- [Print a Schedule](#)
- [Sprint Tips](#)

Jun 2022 Sprint

CW Assistance

CW Nets

FAQ/info

Member List

Newsletter

Pictures

QRP Works

>>> Contact Us <<<



**N2CN Comments - Results are final.**

**Final Results**

### SWA - STRAIGHT KEY CATEGORY

Call	QSOs	Mbrs	Pts	Mul	Scs	Bon	Final	80-40-20 Antenna
<b>W1 Division</b>								
KN1H	30	29	59	18	1062	x2	2124	400' END FED WIRE
AC1KV	34	32	66	13	858	x2	1716	40M EFHW @ 25'
WB1GYZ	23	23	46	11	506	x2	1012	sloping vee
WS1K	14	14	28	10	280	x2	560	69' Center Fed Inverted L & 200' Doublet @ 35'
<b>W2 Division</b>								
KA2KGP	30	30	60	12	720	x2	1440	G5RV up 25'
W2SH	22	22	44	12	528	x2	1056	270' cf dpl @ 45'
K2CWM	17	17	34	10	340	x2	680	Vertical (elevated)
KN2G	14	14	28	8	224	x2	448	55FT FANNED DIPOLE INVERTED VEE
W2JEK	3	3	6	3	18	x2	36	110 ft end fed wire up 20 ft
<b>W3 Division</b>								
K3JED	45	44	89	17	1513	x2	3026	40m Dipole @25', 80m 107' EFRW @ 20'
KC3MIO	35	34	69	18	1242	x2	2484	Doublet 125' @ 45'
K2DEP	31	31	62	14	868	x2	1736	G5RV @ 27 ft
KE3V	18	18	36	9	324	x2	648	Fan inverted Vee @ 25' apex
AK3X	4	4	8	3	24	x2	48	102 ft inv vee@35ft twin lead feed/tuner
<b>W4 Division</b>								
K4BAI	36	35	71	18	1278	x2	2556	20M dipole 30'; 88' cfx 45'; 40M dip 35'; 80M inv
W4RCP	29	28	57	17	969	x2	1938	40m EFHW up 25 feet sloping
K4RHW	33	32	65	13	845	x2	1690	Inverted V at 65'
WB40MM	25	25	50	15	750	x2	1500	G5RV at 35 feet
W4NLT	21	21	42	15	630	x2	1260	84 ft end fed in V configuration at 30ft
KC5F	21	21	42	14	588	x2	1176	80m EFHW up about 40'
K4JFN	21	20	41	13	533	x2	1066	80 M CF Zepp
W4ARH	14	14	28	10	280	x2	560	Ground Mounted Vertical

6/24/22, 8:46 PM

NAQCC Jun 2022 mW

## NORTH AMERICAN QRP CW CLUB

June 2022 QRP/CW mW Sprint

SITE CONTENT

- [Home](#)
- [Awards](#)
- [Become A Member](#)
- [Challenges](#)
- [Contests/Sprints](#)
- [Autoblog](#)
- [Results](#)
- [General Rules](#)
- [Print a Schedule](#)
- [Sprint Tips](#)

Jun 2022 mW

CW Assistance

CW Nets

FAQ/info

Member List

Newsletter

Pictures

QRP Works

>>> Contact Us <<<



**VA3PEN Comments - The scores are final.**

**Final Results**

### SWA - STRAIGHT KEY CATEGORY

Call	QSOs	Mbrs	Pts	Mul	Scs	Bon	Final	80-40-20 Antenna
<b>W1 Division</b>								
K1MEM	23	23	46	15	690	x2	1380	40 Meter Dipole at 40 feet
KN1H	21	21	42	14	588	x2	1176	400' END FED WIRE
WB1GYZ	17	16	33	8	264	x2	528	Sloping vee
K1YAN	9	9	18	6	108	x2	216	G5RV Jr. @ 30'
<b>W2 Division</b>								
KA2KGP	24	23	47	13	611	x2	1222	G5RV up 25'
KN2G	20	20	40	12	480	x2	960	55FT FANNED DIPOLE INVERTED VEE
W2SH	15	14	29	7	203	x2	406	270' cf dpl @ 45'
K2CWM	7	7	14	5	70	x2	140	Vertical (elevated)
WB2LQF	4	4	8	4	32	x2	64	INVERTED L AT 30 FEET
<b>W3 Division</b>								
K3JED	29	28	57	15	855	x2	1710	40m Dipole @25'
KC3MIO	25	24	49	13	637	x2	1274	Doublet 125' @ 45'
WB3YY	6	6	12	5	60	x2	120	80m EFHW at 30 feet
AK3X	6	6	12	4	48	x2	96	102 ft inv vee @35ft. 300 ohm feeders
<b>W4 Division</b>								
KC5F	22	22	44	15	660	x2	1320	80m EFHW up about 40'
K4JFN	15	13	28	12	336	x2	672	80 M CF Zepp
N4SD	11	11	22	6	132	x2	264	EFHW 40-10 @ 35'
N4GW	8	8	16	7	112	x2	224	Butternut HP6V Elevated 8'
WD40BD	9	9	18	6	108	x2	216	Ground-Mounted Vertical
W4NLT	11	11	22	4	88	x2	176	84 ft end fed in V configuration at 30ft
WT4U	6	6	12	6	72	x2	144	80m EFHW Inv-V @ 35'
NA4O	7	7	14	5	70	x2	140	ocf@20'
WGBY	4	4	8	4	32	x2	64	Hustler 6btv grd mnted
W4ARH	4	4	8	3	24	x2	48	40m sloping EFHW @ 20ft

Now these are small operating events. They are not cut-throat contests. There are hundreds, not thousands of participants. They are friendly events geared to QRP and QRPP folks to allow them to get together to see what they can accomplish at QRP or QRPP power levels.

During these two hour long NAQCC Sprint events, everyone is listening for the weaker signals. So it is much more rewarding experience.

I have seen that many who operate in these events do not submit their logs - they just like to get in there and make a few low power contacts.

I have also found that Summits on the Air (SOTA) and Parks on the Air (POTA) activators are also good listeners. I will often answer them while I'm using QRP or QRPP power levels. I have worked some DX stations while using both QRP and QRPP power levels.

With the SOTA, POTA, and the DX stations, I will often have to wait in line and then time my calls carefully in order to get through to them.

All in all, I remain amazed that a QRP or QRPP signal can make it though my rig selector switches, passive Power/SWR Bridge, antenna selector switch, 75 to 100 feet of coax and still radiate enough energy from a wire dipole to allow me to make contacts around the country and around the world. While a QRP signal may light up a small incandescent panel lamp, I do not think that a QRPP signal can do that. Think about that.

So, as you go forward with exploring all of the various aspects of ham radio that are available to you, give some thought to someday trying out some QRP CW operation, or maybe even some QRPP CW operation .

With today's transceivers that have an adjustable power control that can be easily turned to get down to QRP or QRPP power output levels, you do not have to buy anything. Just turn the knob.

Yes, you will have to learn CW if you do not already know it. But, I do not think that you will ever look back and say that leaning CW was a waste of time. Knowing CW allow you to open a lot more of the doors in our hobby.

Jody - K3JZD

## 01JUN22 News Flash

Movie theaters are now worried about having a popcorn shortage.

For our Millennial readers, a movie theater is a place you pay to watch a stranger's TV.

For our Gen Z readers, a TV is a large phone that doesn't have any social media accounts

Look for some construction at the joint. As fully described in the July 5 Meeting Minutes (published here), there is a two part plan.

First step will be to add two ADA Compliant Rest Rooms to the back side of the clubhouse building. Second step will be to expand the meeting room by going out to the front of the clubhouse building.

Here is a sketch showing what is currently being planned :

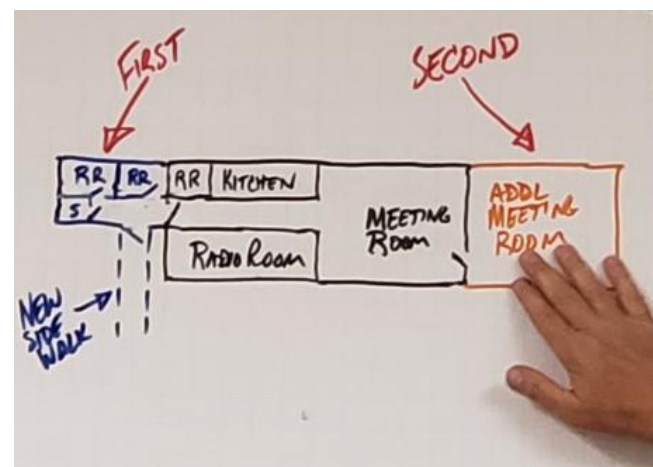



## Used HF Transceivers - Caveat Emptor

de Jody - K3JZD

**Disclaimer :** This article, like most of my non-construction articles, is based on my observations and personal opinions. I do not pretend to be an expert in anything. However, I have found that once you have been in this hobby for a long time, you see the changes that occur and you can draw some conclusions. I share those conclusions and opinions here only to give you some things to consider.

Some time ago, the sage advice that was given to new General Class Licensees was to buy some less expensive used HF equipment and get on the air. By doing so, you could get a feel for what others were using and what sounded good on the air. You could quiz other operators to learn how satisfied they were with their equipment. You could find out from them what they would buy if they were buying something new today.



That was good advice back then because most HF ham equipment was built with common discrete components and was repairable. And being tube based, the radios were generally quite durable. With those older radios, it was almost impossible to get stuck with a used HF radio that couldn't be repaired.

Following this 'buy less expensive used equipment first' strategy, one could then take their time to decide what to buy next. One could target a new radio if one could afford to do so. If not, then moving up to a more expensive used radio



might be a more suitable strategy. Either way, one could be on the air and continue to enjoy operating while saving up the money for their next purchase.



However, that started to become bad advice shortly after digital frequency displays began to appear on the HF ham equipment. Initially these digital frequency display units were driven by circuit boards that contained common discrete digital logic integrated circuits (ICs or chips). If a portion of the digital frequency display quit working, then replacing one or more of these discrete chips would usually get it going again. But, if it was not a chip problem, then it usually meant that the digital display unit or display panel needed replaced.



While these earliest discrete digital logic chips have remained readily available even up until today, the problem soon became the availability of replacement digital display units or panels. Digital display panels are constantly being improved upon. As the manufacturers designed, manufactured, and sold their newest digital display panels, they ceased manufacturing their older digital display panels. So, as time goes on, the older digital display panel that you now need to repair your particular radio may have become obsolete and no longer available.

A HF radio with an obsolete and unavailable digital display panels that has burned out segments, or has gone completely dark, would put that HF radio out of business unless it also had a mechanical frequency indicator. All of the other sections in the radio may still be functioning fine, and the knob may still change the frequency, but not having any frequency displayed makes the radio rather hard to use.



As larger display panels began to appear that showed you more than just the frequency, things got much worse. These more complex display panels required more complex circuits to drive them. This meant driving them from either custom large scale integration (LSI) chips or from small dedicated custom computer chips mounted on display driver boards. With these radios, in addition to these more complex display panels becoming obsolete and unavailable, the complex custom components used to drive them can also become obsolete and unavailable. And whenever you have lost one of these large display panels, you will lose visibility to more than just the frequency indication.

A HF transceiver that uses a digital display panel, that had cost hundreds or thousands of dollars whenever it was new, can be reduced to being a paperweight once it ages and an obsolete and unavailable display panel or display panel driver circuit fails. Perhaps you had bought this transceiver used and work-



ing well, and you had obtained it at a pretty decent price. But, if that obsolete and unavailable display panel or display driver board goes out, it may suddenly totally lose all of its value.



About all you can hope for is that the manufacturer has kept a large inventory of all of their display panels and display driver boards for that particular radio. But, if you had bought it used at a decent price, you will probably not like what that manufacturer is going to want to charge you to repair it.

Even if he was willing to sell you those obsolete NOS (New Old Stock) parts out of his remaining inventory, you will probably not like his parts price either. And, things are now pretty tight and tiny in most of the newer HF radios, which makes doing any self replacement much more difficult.





All of this is leading up to my suggestion to be very careful about buying any used HF radio that has any kind of a digital display panel or more complex display panel. If you do buy an older one, I think that you want to get it at an extremely good price. And you will need to understand that whenever the display goes out, it is probably going to be reduced to having zero value and will only be good for parting out or recycling.

If you buy a newer used HF radio, initially there is less of a risk of getting one with obsolete and unavailable display panel parts. But as it ages, you will have to consider the possible risk of you having to pay to have a display problem repaired. And if you keep it long enough, then you are going to eventually run into the risk of finding out that your display panel parts have become obsolete and unavailable. So, I think that you will always want to get any newer used HF radio at a great price.



No, I do not know exactly where the dividing line is between an 'older' and a 'newer' used HF radio. Nor do I know what an 'extremely good price' or a 'great price' would be. It has been my experience that most hams who are selling their used HF radios have a very hard time coming down to what the buyer would consider to be a 'great price' or an 'extremely good price'. The seller knows what he paid for it. And since it is still working fine, he generally feels that it is worth far more than the buyer is willing to pay. Most likely the seller has not considered how the sudden loss of a display could either create a large repair bill or render that radio useless whenever he priced it for resale.

Unfortunately, our newer ham radio equipment has now become like most other consumer electronics : disposable. You will certainly get a lot more features for your money. But like it or not, this newer equipment has become disposable. As time goes on, I think that the only thing that will sell well at the hamfests will be the old classic HF radios that still have mechanical frequency indicators. I think that those who bring out their newer HF radios that have digital frequency panels or have the more complex display panels will probably be taking them back home with them because they are holding out for more money than the educated buyers are willing to risk.



I think that the newer HF transceivers with the custom DSP circuits, and the very newest SDR transceivers with custom embedded computers in them, will be even harder to sell as used radios. They now add in new risks of encountering obsolete and unavailable custom DSP components and obsolete and unavailable custom embedded computers. So, as these newest HF transceivers show up as used radios, I think that they represent an even larger purchase risk.

As hard as it is to get used to, I've come to think that the strategy of spending a lot of time making decision on what HF transceiver to buy, saving up enough money to buy it, and then planning on keeping it until it dies will become the new normal. I think that any older but still working HF transceivers that you presently own that you want to move out of your shack in order to make space for your new purchase will probably have to be gifted.

So, as you consider making your new HF transceiver purchases, keep these thoughts in mind. And as you give advice to new General Class Licensees, do not steer them into any making any newer used equipment purchases without making them aware of the increased risks. If they say that their budget only allows them to buy used HF equipment, make sure that they know that they need to obtain that used HF equipment at a very good price and they also need to be aware that an obsolete component failure could reduce it to becoming completely worthless.

Jody – K3JZD



## Lesson Learned

de Bob – WC3O

At the clubhouse we have Heil headsets at each of the three HF stations. They hang on a hook under the radio bench, below each radio. We've had these headsets for years. Well, time moves on and normal wear and tear occurs. All three sets were showing their age. There are inner pads that cover the speakers in each cup. There are the vinyl cushions that rest against your head (Those were still in good condition). There are covers that isolate between the cushions and your head. There is a windscreen on the boom mics. All of these items are available through Heil Sound as replacement parts when the time comes. Well, the time came for all three headsets at the club. We replaced the inner pads and the outer covers that go over the vinyl cushions. But that's not what this article is about! This article is about the windscreens for the mics.

Heil wants \$6.00 for these little pieces of foam. 6 bucks. Me, being a cheap ham, wanted to do better. I found someone on ebay selling similar size windscreens for a fraction of the cost of the Heil part. I ordered them. I received them. I installed them. They fit pretty well. Yipee!

A while later using the headsets I started to realize they don't sound quite right. With the radio monitor on I could clearly hear my breath. My Ps were popping and my Ss, well it was sibilance city! I remembered these headsets sounding much better.

As it turns out there is more to those windscreens than just simple foam. I bit the bullet and replaced all of the crappy windscreens with the correct Heil part.



BOOM! The headsets once again sounded great! No more breath. No more Ps. No more SSSSSSSs.

Short story long, just get the right part. It was too easy.

Bob - WC3O

## Skyview Table

de Jody – K3JZD

At the Skyview Swap & Shop, we always have our famous Swap & Shop Table.

The Swap & Shop Table always has a very broad selection of items for sale. They are either items that have been donated to Skyview or items that are there on consignment from Skyview Members.

Now is the time to look around and see what you have laying around that you no longer use and are willing to donate to Skyview. Ham related items are best, but computer related items, power tools, and other electronic or electrical items also sell well.

If there are items that you would like to donate to Skyview, bring those items to Skyview on or before Saturday morning, August 27th. Skyview members will price them to sell and promote them during the Swap & Shop. All proceeds from the sale of these donated items will go to Skyview.

If you have an item that you would like to place on the Skyview Table as a consignment item, you must bring your item to Skyview on or before Saturday morning, August 27th. You must put your selling price on your item and you must tell the Skyview member who receives it what your minimum acceptable selling price is (Note that most attendees who shop the Skyview Table are looking for bargains). The proceeds from the sale of your consignment item will go to you. If you wish to donate a portion of that back to Skyview for handing your item, that is up to you.

And, while doing your Swap & Shop shopping, be sure to stop at the Skyview Table. There are always lots of bargains there. And like most tables, the deals on the remaining items get better as the day goes on. The Skyview Table will be located near the Skyview Kitchen Pavilion, so stop there after you have filled up on Skyview Burgers and Dipole Dogs.



# Uniontown Amateur Radio Club

## 72nd Annual Gabfest



## Saturday, August 13, 2022



***The Uniontown Amateur Radio Club – W3PIE will conduct our  
72<sup>nd</sup> Annual GABFEST on a NEW DATE  
Saturday, August 13<sup>th</sup>, 2022!***

The gates open around 8:00 AM with vendors welcome at any time prior to 8:00 AM! As current Covid-19 restrictions are changing frequently, please check our web site [www.w3pie.org](http://www.w3pie.org) for Covid 19 restriction updates, if any. Social distancing is a must!

The GABFEST will be held at the Radio Club Grounds located on Old Pittsburgh Road just off Northgate Highway/RT 43 Mon Fayette Expressway--- near RT 51 and US RT 119 in Uniontown, PA

***Talk in will be provided on 147.045 + (Full Time PL 131.8) Just call for W3PIE Gabfest Talk-In.***  
*This talk-in is provided for directions and Gabfest information. No check in is needed if you know how to get here!*

As always, free parking is available! Refreshments available! Free Swap-N-Shop Set-up with registration! Check our web site prior to the event for Covid 19 Restriction Updates.

Hamfest Prizes for our event
1 <sup>st</sup> Prize- Yaesu FTM200DR VHF/UHF Fusion Mobile Radio
2 <sup>nd</sup> Prize- Yaesu FTM3100R VHF Mobile Radio
3 <sup>rd</sup> Prize- Yaesu FTM3100R VHF Mobile Radio

**Other prizes to be determined**

*Address of UARC-W3PIE is 433 Old Pittsburgh Rd, Uniontown, PA*

Contact Tony Alviar 724-430-1277 (M-F 8-4) or George Syner 724-439-1554 (leave message if no answer) if more information is needed. Also, Information is available anytime on 147.045 + (Full Time PL 131.8). Additionally- email [officers@w3pie.org](mailto:officers@w3pie.org) for information

***Look forward to seeing everyone this year!***

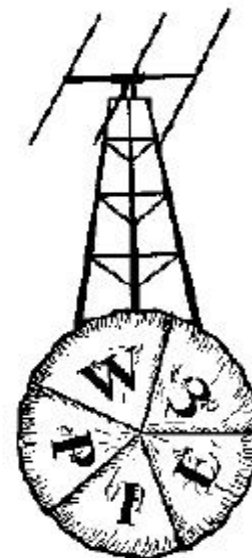

## Welcome New Members !!

Welcome the following Skyview Radio Society Members who have joined us since publishing the June 2022 newsletter:

**KC3UIJ - Chris Vanek - Pittsburgh 15235**

Remember that something is going on up at 'the joint' every Tuesday. Sign up for the K3MJW Groups.io Reflector to get the latest news and event announcements by email.

If you are a reader who is interested in becoming a Skyview member, then go to:  
<http://www.skyviewradio.net/> for information.

If you are a reader who is not yet a ham, and you are interested in becoming a ham, , then go to:  
<http://www.skyviewradio.net/> for information.

**This Box is Empty**

## Skyview Radio Society Roster as of 31 JUL 22

NM3A	KB3HPC	N3 MRU	KC3 SDJ
N3AFS	KA3HPM [SK]	KS3N	KC3 SKX
KB3APD	K3HSE	G4 NFS	KC3 SNZ
NA0B	KB3HXP	KB3NSH	KB3 SOU
WI8B	AC3HZ	AJ3O	K3 STL
N3BAH	AG3I	WC3 O	KC3 STS
W3BUW	AC3IE	WO3 O	KC3 STV
KF3C	KC3IIO	KC3OCA	KB3 SVJ
KC3CBQ	W3IU	KC3OCB	KC3 TEX
K2CI	K3JAS	KC3OCC	WV8 TG
K3CLT	KG4JBB	K3 OGN	N3 TIN
K3DCG	N3JLR	N3 OIF	W3 TLN
KC2EGL	KA3JOU	KB3OMB	N3 TTE
KC3EJC	ND9JR	KB3ORO	AG3 U
AB3ER	K3JZD	NK3P	NS3 U
N3ERW	KC3KEI	K3 PC	KC3 UIJ
K3ES	WA3KFS	KC3PEM	N3 UIW
KB3EYY	KB3KHR [SK]	KC3PIM	W3 UY
AC3EZ	AC0KK	K2 PMD	KX3 V
WB3FAE	K3KR	KE3PO	K3 VRU
K3FAZ	W4KV	W3 PRL	N3 VXT
KC3FEI	KC3KXZ	KC3PSQ	W3 VYK
K3FH	WE3L	KC3PXQ	N3 WAV
K3FKI	WA3LCY	NU3Q	K3 WM
KC3FWD	KC3LHW	WQ3 Q	N3 WMC
AC3GB	W3LID	KC3QAA	K3 WWP
N2GBR	WB3LJQ	KC3QIR	N3 XF
AC3GE	KB3LND	KC3QWF	KB3 YJQ
KC3GIL	K3LR	NJ3R	W3 YNI
KC3GIN	KC3LRT	K3 RAW	W3 YNX
KC3GPM	AB3LS	K3 RMB	WA3 YWU
K3GT	KC3LZH	KC3RPE	K3 ZAU
AB3GY	N2MA	KC3RPP	W3 ZVX
KC3GZW	KC3MBM	W3 RRK	
NC3H	N3MHZ	I2 RTF	
NY9H	KC3MIQ	KD3RVR	
WB3HFP	K3MJ	KQ3S	
WA3HGW	K3MRN	K3 SBE	

Notes: Only Call Signs are being published. Refer to QRZ.COM for more information. (Unable to publish those without Call Signs. )





## Kul - Links

Jody - K3JZD

There is lots of stuff out on the Internet... Some of it can brighten your day. Some of it can educate you.

I can't really copy and past it all in here. But, I can point you at some of it . . . . .

Paul - K2PMD sent in this link to what could be considered a poor man's Geochron. It has lots of features, it will run on older PCs, and it is at a price that most hams will like :

<https://www.g4eli.com/world-map>

I'll consider any Kul - Links that you find.  
Email then to me at: K3JZD AT ARRL DOT NET  
They might just end up in the next issue

## Previous Issues

Previous Issues of the Q5er are available at

<http://www.nelis.net>

Next Newsletter will be **October 1, 2022**  
Closing Date For Submissions : **Sep 15, 2022**

**K3JZD AT ARRL DOT NET**

## Become Well Known Publish in the Q5er

**The Q5er goes to other clubs and is  
available to all on our web site.**

**Submissions to : K3JZD AT ARRL DOT NET**

**>>>>> WARNING <<<<<<**

An Alarm System has been installed up at the joint. Do Not go in there on your own until you learn how to disarm and rearm it.

## \*\*\*\* Skyview VE Testing \*\*\*\*

**For Testing Dates, See :**

<http://www.arrl.org/find-an-amateur-radio-license-exam-session>

**Time:** Usually 8:15 AM

**Location:** Skyview Clubhouse Meeting Room  
2335 Turkey Ridge Rd  
New Kensington PA 15068-1936

**Contact:** William C. Dillen  
(724) 882-9612

**Email:** [bdillen@comcast.net](mailto:bdillen@comcast.net)

**Please E-Mail or call to register!!!**

While walk-ins are accepted, the exam session may be cancelled if no candidates are scheduled.



Q5er Editor & Publisher: Jody Nelis - K3JZD

This newsletter may be freely forwarded.

Permission is granted to other Amateur Radio publications to reprint articles from this issue, provided the original author and "*The Skyview Q5er*" are credited.

email your comments and article submissions to: [K3JZD AT ARRL DOT NET](mailto:K3JZD@ARRL.NET)

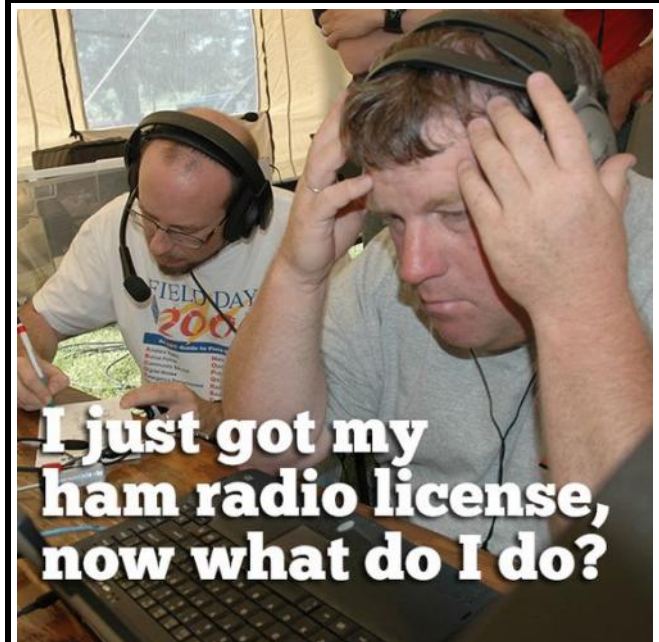

**I just got my ham radio license, now what do I do?**

That's Easy . . . .

Come up to the Skyview Clubhouse on any Tuesday and ask !!!

And See : <https://tinyurl.com/y79tqsr8>

All General Information about the Skyview Radio Society is at <http://www.skyviewradio.net>

Subscribe to K3MJW [groups.io](https://groups.io/g/K3MJW) reflector for All Current News & Activities : <https://groups.io/g/K3MJW>  
If you want to keep up with what is going on NOW, that is the place - have it forward msgs to your email



Is this how your dining room looks ??

Send in pictures of your Ham Shack